

Arma-Chek®
Silver

THE BRILLIANT COVERING WITH
ARMAFLEX® INSULATION DESIGNED
FOR FAST INSTALLATION, DURABILITY
AND EASY CLEANING

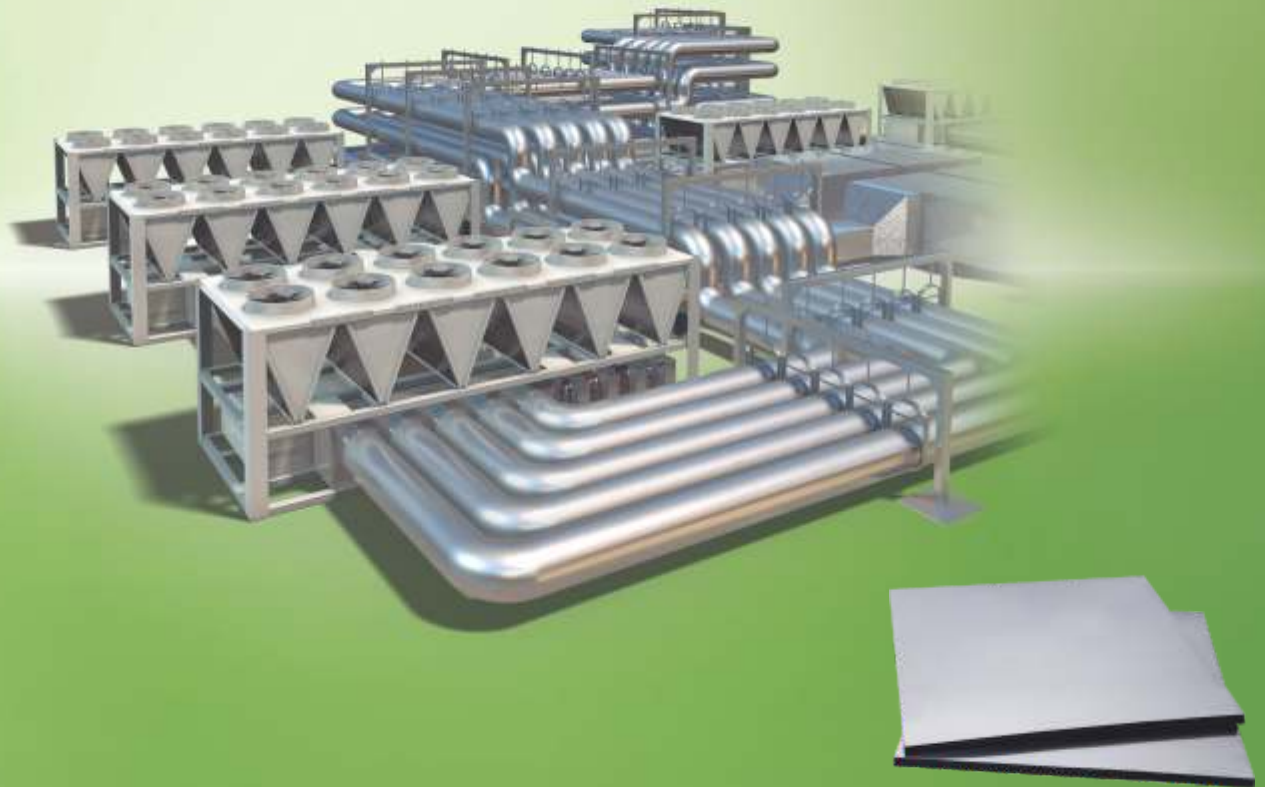

- Pre-covered system saves installation time compared to metal jacketing
- System with matching tape, elbow and t-parts
- Easy to clean aesthetic surface in metallic look
- Light weight and flexible
- Strong and resistant surface
- Good chemical resistance
- Professional training provided by Armacell

CLADDING FOR SUPERIOR PERFORMANCE

Arma-Chek® Silver is based on high performance Class 0 Armaflex® insulation combined with a UV resistant metal finishing for aesthetic indoor and outdoor installations.

The product saves installation time with the pre-covered System compared with traditional cladding. In addition, the self-adhesive tubes are with tangential cut for improved adhesion security.

Watch the video at <http://youtu.be/x0nHyDRcEzo> and see the difference!

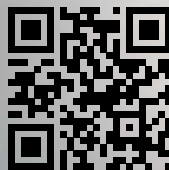

PRE-FORMED PARTS

Specially designed Arma-Chek® Silver elbows and t-pieces offer you additional installation time savings. The pre-formed parts match the Armaflex® tubes perfectly to complete the system.



UV-RESISTANCE

The UV-resistance of Arma-Chek® Silver covering is constantly tested with Weather-O-Meter equipment according to ISO 4892. The samples are exposed to simulated weather for at least 15000 hours, which equals to estimated 15 years of outdoor application.



SURFACE PRESSURE RESISTANCE

Unlike traditional metal cladding, Arma-Chek® Silver recovers it's original shape after pressure is exerted on the surface.

This property prevents lasting dents and ensures a durable installation.

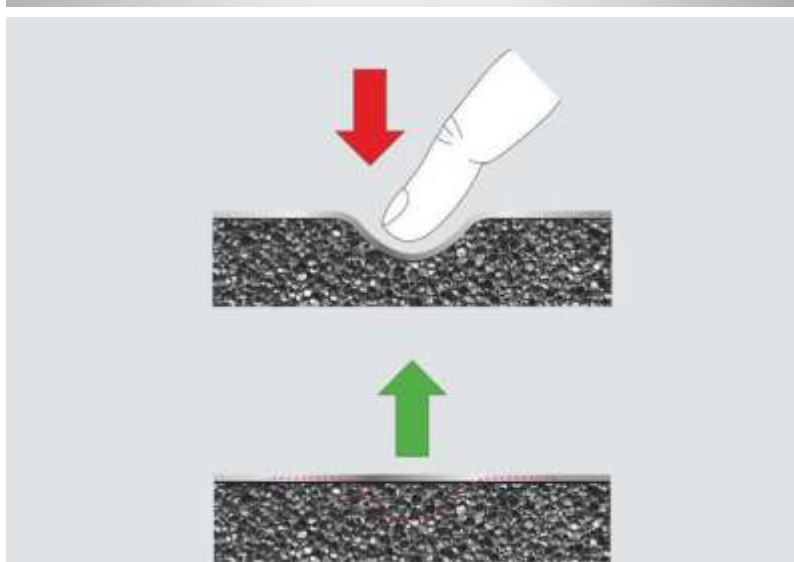

Technical Data - Arma-Chek® Silver

Brief description	Arma-Chek® Silver is a covering system with a double layer laminate of aluminium, coated with a special UV protection and a PVC backing. Enclosing an Armaflex® substrate, Arma-Chek® Silver jacketing is highly puncture and tear resistant as well as flame retardant. Arma-Chek® Silver can be used for insulation and protection of HVAC and Refrigeration systems inside or outside.
Material type	Insulation: Highly flexible, closed-cell elastomeric foam material based on synthetic rubber. Covering: Double layer laminate of aluminium, coated with a special UV protection and a PVC backing.
Colour	Base material is black, Covering is metallic (silver).
Product Range	Arma-Chek Silver is available in a range of pre-insulated sheets as well as single covering.
Applications	Insulation and protection of pipes, ducts, valves and vessels of refrigeration and air conditioning equipments, clean room environments, food industries etc.
Assembly	The Armaflex® and Arma-Chek® installation manuals should be consulted before assembly. We also offer special installation courses for the application of Arma-Chek®. Please consult our Technical Services.
Remarks	When calculating the insulation thickness required please use an external surface coefficient of 8 W/(m²·K). For outdoor use please note: Testing regarding UV resistance of these materials showed excellent results. When used on outdoor applications the materials showed very good durability even under UV exposition. However, due to the unpredictable nature of outdoor conditions there may be occasional weathering influences which cannot be tested in advance. Therefore, installation in extreme environments is not recommended. Please contact our Technical Services if in doubt.

Property	Value/Assessment						Special Remark
Temperature Range							
Temperature Range	max. service temperature		+110 °C for substrate (+85 °C if used on flat surfaces)			(+75 °C for the silver jacketing)	Tested to EN 14706 and EN 14304
	min. service temperature		0 °C				
Thermal Conductivity							
Thermal Conductivity	θ _m		0	+20	+40	[°C]	Tested to EN 12667
	λ	≤	0.035	0.037	0.039	W/(m · K)	
Water Vapour Diffusion Resistance							
Water Vapour Diffusion Resistance	μ		≥			60,000	Tested to EN 12086
Fire Performance							
Reaction to Fire*	Fire performance acc. to building regulation		Class 0			Surface Spread of Flame: tested to BS 476 Part 7:1997	
	Surface Spread of Flame		Class 1				
	Fire propagation		Total index performance (I) ≤ 12			Fire Propagation: tested to BS 476 Part 6:1989	
			Sub index (i _r) ≤ 6				
Other Fire Class*	Flammability		HB, V-0			Tested to UL 94	
	FM Approved					Tested to FM 4924	
Practical Fire * Behavior	Self-extinguishing, does not drip and does not spread flames						
Weight	approx. 340 g/m² (covering)						Tested according to EN 22286
Material thickness	approx. 230 μm (covering)						Tested according to EN 22286
Resistance to Mechanical Impact	Good puncture and tear resistance						
UV Resistance [#]	Excellent (Covering)						Tested according to ASTM G 26A / ISO 4892-2
Safety and Environment *	Dust- and fibre-free Zero ODP and GWP						
Storage and Shelf Life	Shall be stored in dry & clean area. Away from direct sunlight						

All data and technical information are based on results achieved under typical application conditions. Recipients of this information should, in their own interest and responsibility, clarify with us in due time whether or not the data and information apply to the intended application area. Installation instructions are available in our Arma-Chek® installation manual.

In outdoor applications there may be discolouration of the covering, but it will not have any negative effect on functionality of the product.

* For Class 0 Armaflex® material (Base material) only

[#] In outdoor applications the colour may fade. This does not have any impact on the functionality of the covering or the insulation material.

GAT No. 744-745, Village Lonikand, Pune Nagar Road • Pune 412216 •
Maharashtra • India
Phone +91 20 66782000
www.armacell.in • info.isa@armacell.com
CIN: U24293PN2005FTC131939